

CAYMAN ISLANDS

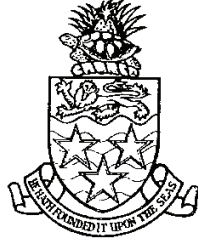

Supplement No. 17 published with Gazette No. 2 of 1975

THE TRAFFIC LAW
[No. 16 of 1973]

THE TRAFFIC REGULATIONS

Date of operation: December 16, 1974.
Government Notice 349/94

CAYMAN ISLANDS

THE TRAFFIC LAW.

(No. 16 of 1973)

THE TRAFFIC REGULATIONS

In exercise of the powers conferred upon the Governor in Council by virtue of sections 51, 17 and 82 of the Traffic Law, the following Regulations are hereby made.

Short title
and
commence-
ment

1. These Regulations may be cited as the Traffic Regulations, and shall come into force in whole or in part on a day to be appointed by the Governor by Government Notice published in the Islands.

Interpre-
tation.

2. In these Regulations —
“Law” means the Traffic Law;
“section” means a section of the Law; and section 2 applies.

Forms,
Schedule.

3. Forms required by the Law to be prescribed are set forth in the schedule.

Licence plates,
bicycle
tags and
coupons.
(Section
11 (2), (iii)
and (iv)).

4. (1) The official vehicles used by the Governor in person shall carry, in lieu of a licence plate a crown or the coat of arms of the Islands.

(2) The licence plates, bicycle tags and coupons required by sub-paragraphs (iii) and (iv) of section 11 to be prescribed are prescribed in the schedule.

Vehicle
testing,
places
and times.
(Section
24(1)).

5. Driving and vehicle testing shall normally be carried out between the hours of 0830 a.m. and 4 p.m. on Mondays to Fridays other than public holidays at the Police Station, George Town and the Post Office, Cayman Brac and at such other times and places as the Commissioner may by public notice appoint.

Display of
plates,
tags and
coupons.
(Section 26
(1)).

6. (1) For the purposes of subsection (1) of section 26, the coupon shall be displayed at all times on the side of the front windshield furthest from the steering wheel or, where no such windshield is fitted to the vehicle, in the area where the windshield would or ordinarily be located, save that, in the case of trailers, the coupon shall be displayed on the near side back of the trailer; the licence plates or trade plates as the case may be shall be displayed at the front and rear of the vehicle, or at the rear only in the case of a trailer, so that the plate shall be parallel with the ground and not

more than 36 inches and not less than 8 inches clear of the ground.

(2) For the purpose of subsection (2) of section 26, the bicycle tag shall be attached to a hub, the handle bars or under the saddle of the bicycle.

(3) Coupons, plates and tags required to be displayed must be visible and readable at all times.

Age quali-
fications.
(Section
32 (a) 1.

7. The age qualifications for drivers of motor vehicles required to be prescribed by paragraph (a) of section 32 are —

- | | | |
|-----|---------------------------|----------|
| (a) | for driving a motor cycle | |
| | do a motor car, | |
| | do a station wagon, or | |
| | do a rent-a-car, | 17 years |
| (b) | do a truck not exceeding | |
| | 3 tons capacity | 18 do |
| (c) | do any other vehicle | 21 do |

save that a person of any age, if permitted so to do by the Commissioner, may drive an invalid carriage.

Trade
plates
and
coupons.
(Section
28(1) 1.

8. The dimensions of trade plates required to be prescribed by section 28(1) shall be 6 inches in height and 12 inches or upwards in length with figures 3 inches in height or, in the case of motor cycles and invalid carriages, of such dimensions as may be approved by the Commissioner from time to time.

"L" plates.
(Section
40(a) 1.

9. The "L" plates required to be prescribed by paragraph (a) of section 40 are prescribed in the schedule and shall be prominently displayed on the front and rear of every vehicle when, and only when, such vehicle is being driven by the holder of a provisional licence.

The
driving
test.
(Section
41(3) 1.

10. The following are the requirements for the purpose of subsection (3) of section 41 for the passing of a driving test —

the applicant shall satisfy the examiner that he is capable of driving the class of vehicle in respect of which he is seeking a licence to drive and in particular that he can —

- (a) read in good daylight (with the aid of glasses if worn) a licence plate number fixed to a motor vehicle at a distance of 60 feet;
- (b) start the vehicle from rest smoothly and efficiently and maintain it on an accurate course as directed by the examiner;

- (c) make turns to the right and left with accuracy and without endangering other road users;
- (d) stop the vehicle smoothly and efficiently at various speeds and make emergency stops;
- (e) operate all the controls of the vehicle efficiently and with safety;
- (f) if the vehicle is capable of being reversed, drive and turn it in reverse accurately and smoothly;
- (g) stop and start the vehicle on gradients;
- (h) turn the vehicle completely about by the use of forward and reverse gears within a reasonable compass;
- (i) make such other normal manoeuvres as the examiner shall direct; and that
- (j) he is familiar with the road code and generally with the provisions of the Law, particularly sections 55 to 59; and

(Section
41(3) and
Sections
55 to 59).

the applicant shall be required to pass a written examination to ascertain whether he has the knowledge required of him by paragraph (i) and to answer not less than 80% of the questions correctly.

Photographs
of taxi
drivers.
(Section
43(1)).

11. The form of photograph prescribed for the purpose of subsection (1) of section 43 shall be unmounted and taken full face without a hat and of dimensions not more than 2" x 1-1/2", and not less than 1-1/2" x 1".

Omnibus and taxis
(Section
44(2)).

12. (a) Every taxi and omnibus shall be plainly designated as such by having the words TAXI or OMNIBUS, as the case may be, painted on the sides or doors of the vehicle and above the centre of the windshield in yellow lettering not less than two and a half and not more than three inches in height on a black or yellow background, and taxis shall at night display at the front above the centre of the windshield the word TAXI electrically illuminated in amber on black or black on amber coloured letters not less than two and a half or more than three inches in height, which illumination may be switched off at times when the taxi is carrying a passenger for hire; omnibuses shall carry such special illumination as the Commissioner may from time to time approve.

(b) There shall be prominently displayed inside every taxi and omnibus a notice in a form approved by the Commissioner showing —

- (i) the registration number of the vehicle; and
- (ii) the conditions of hire or use and a fare table.

(c) The driver of a taxi or omnibus, as the case may be, shall not refuse to accept a passenger for a lawful journey

while the omnibus has a vacant seat or the taxi is plying for hire.

(d) An omnibus is not obliged to set down or pick up passengers otherwise than at a place designated by the Commissioner as an omnibus stop and marked as such.

(e) Every driver in charge of a taxi shall —

- (i) be clean and neat in person and dress;
- (ii) wear prominently a numeral badge of a design approved by the Commissioner;
- (iii) refrain from using in his vehicle any radio set other than radio telephone unless he has first obtained the consent of any passenger he may be carrying.

(f) Any taxi driver may refuse to carry —

- (i) any animal;
- (ii) any item of baggage which cannot conveniently and safely be stowed in his vehicle.

(g) No person shall —

- (i) hire any taxi unless he can pay the legal charge of such hire;
- (ii) avoid or attempt to avoid payment or any legal charge incurred by him for the hire of any taxi; or
- (iii) withhold his true name and address from any taxi driver lawfully demanding payment of a legal charge incurred by him for the hire of a taxi, which demand remains unsatisfied.

Rent-a-car
firms.
(Section
45(1)).

13. The following are the rent-a-car firms required by subsection (1) of section 45 to be prescribed —

Cico Rent-A-Car
Ace Rent-A-Car
Rudi's Rent-A-Car
Sunbeam Rent-A-Car
Mango Tree Rent-A-Car
Cayman Car Rentals
Egbert Murray
Caribbean Motors
Robinson's Rent-A-Car U-Drive
Conmac U-Drive
Cayman Islands Basic Industries Ltd.
Able Car Rentals Ltd.
Coconut Car Rentals Ltd.
Buccaneer Inn Hotel U-Drive
B.B. Grant Rent-A-Car U-Drive
Kensons Rent-A-Car
Maple Tatum Rent-A-Car.

Tyres.
(Section
53(1)(a))

14. (1) All vehicles used on the road other than special vehicles specifically exempted by the Commissioner shall be fitted with pneumatic tyres in sound condition and having a tread depth of at least one millimetre around the circumference of the tyre and across three-quarters of its breadth, including any tyre on a spare wheel carried by the vehicle.

(2) Radial tyres shall not be mixed with other tyres on the same axle and, if fitted to the front axle, must be fitted all round (spare included).

Brakes
(Section
53(1)(b))

15:2 Every vehicle other than a special vehicle specifically exempted by the Commissioner or a trailer of capacity not exceeding two shipping tons shall have two independent braking systems in good working order, one of which is capable of being operated while the vehicle is stationary, and one of which is capable of bringing the vehicle to a halt within 50 feet when travelling at 25 miles per hour.

Lights.
(Section
53(1)(c))

16. (1) No mechanically propelled vehicle other than emergency vehicle shall be equipped with —

- (a) any external light of a colour other than white, red or amber; or
- (b) any light other than a headlight or headlights which is capable of having its beam moved while the vehicle is in motion; or
- (c) any light other than headlights, stop lights, emergency lights or trafficators having an output in excess of 7 watts.

(2) For the purposes of this Regulation —

- (a) a headlight is a light carried at the front of a vehicle capable of being dipped to the left when the vehicle is in motion;
- (b) a sidelight is one of a pair of lights placed on each side of the front of a vehicle;
- (c) a rearlight is a red light placed at the rear of a vehicle;
- (d) a stoplight is a red light placed at the rear of a mechanically propelled vehicle which becomes illuminated or the illumination of which becomes intensified when a brake of the vehicle is actuated, so as to be clearly visible by day and by night;
- (e) a reverse light is a light placed at the rear of a vehicle which becomes illuminated only when the vehicle is engaged in reverse gear;
- (f) an emergency light is a pulsating red or amber light designed to be used only for the purpose of giving warning of an emergency in connection with the

vehicle to which it is fitted;

- (g) a reflector is a device for reflecting in red the beam of a light turned in its direction;
- (h) a registration plate light is a light illuminating the rear number plate of a vehicle at night time so as to render it readable at a distance of 30 feet; and
- (i) a trafficator is a pulsating or flashing light placed at each side of a vehicle for the purpose of indicating that such vehicle is about to turn in the direction of the side where such light is made to flash and designed so as to be clearly visible by day as well as by night.

(3) No red light of any kind shall be displayed at the front of any vehicle.

(4) No white light of any kind other than a reverse light or a registration plate light shall be located at the rear of any vehicle.

(5) Subject to regulation 24 no amber light of any kind other than a trafficator or emergency light shall be located or displayed so as to be visible from the rear of any vehicle.

(6) No external light shall be carried less than eighteen inches or more than four feet above the ground level on any vehicle unless specifically authorized by the Law or any Regulation.

(7) The following are the minimum lighting requirements for the vehicle to which reference is made —

- (a) bicycles shall have one light fixed in front which may or may not be capable of being dipped to the left, one rear light attached to the off-side rear fork or a reflector visible from the rear, all so devised that the presence and movement of the bicycle shall be clearly visible at night time within a range of 50 yards;
- (b) motorcycles shall have a headlamp in front and a rear light, reflector, stoplight and registration plate light at the rear;
- (c) mechanically propelled vehicles other than motorcycles, invalid carriages and special vehicles shall have one pair of sidelights and not less than one or more than two pairs of headlights at the front, two rear lights, two reflectors, two stoplights placed on each side of the vehicle and a registration plate light at the rear and shall have trafficators so placed as to be clearly visible from the front and rear of the vehicle when in operation by night and by day; each pair of lights shall be of equal candle power;
- (d) special vehicles and invalid carriages shall be

equipped with such lights as, notwithstanding these Regulations, the Commissioner may specifically require; and

- (e) emergency vehicles shall be equipped with such additional lights as the Commissioner may specifically require and, in addition, may carry a blue rotating light in such a position as to give warning of their presence and of their movements in every direction.

Horns, etc.
(Section
53(1)(d))

17. Every bicycle shall be equipped with a hand operated bell and every mechanically propelled vehicle shall be equipped with means of giving audible warning of its presence but no mechanically propelled vehicle other than an emergency vehicle shall be equipped with any gong, bell, siren or any device capable of giving two or more different sounds in succession.

Driving
mirrors
(Section
53(1)(g)
(Section
77(b))

18. Every mechanically propelled vehicle shall be equipped with at least one driving mirror so placed that the person driving it shall have a clear view of traffic approaching from his rear.

Silencers
etc.
(Section
53(2)(c))

19. Every vehicle propelled by an internal combustion engine shall be fitted with a silencer or a silencer in combination with a muffler according to its manufacturer's standard design and no person shall make modification to such silencer or muffler so as in any way to increase the noise of escaping exhaust gas. Such silencers and mufflers shall be maintained in a leak proof condition and in sound mechanical order.

Unsafe
loading.
(Section
53(5)(d))

20. Where any vehicle carrying goods or passengers appears to be loaded in such a way as to be liable to cause a nuisance or danger to any person a constable in uniform may require the driver thereof to take such lawful steps as shall remove the risk of such nuisance or danger occurring and such driver shall comply with such requirement which may include the use of tailgates, coverings and devices for the prevention of spillage.

Speed-
ometer.
(Section
53(6))

21. Every mechanically propelled vehicle capable of travelling under its own power at a speed in excess of fifteen miles per hour shall be fitted with a speedometer clearly visible to the driver and indicating to him the rate of travel of the vehicle in miles or kilometers per hour up to its maximum designed speed with an accuracy of not less than ninety per cent.

Speed
limits.
(Section
63(1)).
(Section
77(c)).

22. A maximum speed of 25 miles per hour is prescribed by virtue of paragraph (c) of section 77 in respect of all vehicles driven in the following places —

- (a) The town of West Bay including all that area to the North of Grid Line 214220m N.
- (b) The Town of George Town including all that area:- bounded on the north by the Grid Line 2135000m N and on the east by the Grid Line 463000m E and on the West and South by the sea.
- (c) The town of Savannah including all that portion of the main road passing through Savannah between the Grid Lines 467660m E and 469040m E.
- (d) The Town of Bodden Town including all that part of the main road passing through Bodden Town between the Grid Lines 472350m E and 475050m E.
- (e) The Town of East End including all that portion of the main road passing through East End between the Grid Lines 487440m E and 2136120m N.
- (f) The town of North Side including all those portions of road between the Grid Lines 2138680m N and to the west where the road crosses Grid Lines 476300m E.
- (g) The town of Breakers including that portion of the road passing through Breakers between the Grid Lines 478480m E and 479500m E.

by reference of the Map of Grand Cayman (Directorate of Overseas Surveys - Series E821, Sheet 1 and 2.)

- (h) The whole of Little Cayman and the following parts of Cayman Brac.
 - (1) From the Airport to a point a quarter of a mile east of Faith Hospital.
 - (2) From a point one quarter of a mile west of the High School to a point one quarter of a mile east thereof.
 - (3) From a point one quarter of a mile west of Tibbetts turn, to the end of the public road at Spot Bay.
- (i) Those parts of roads specifically marked by prescribed 25 MPH speed limit signs.

Prescribed
radar
speed
meters.
(Section
63(2)).

23. The following are prescribed radar speed meters for the purposes of subsection (3) of section 63(2) —

- (a) the Marconi portable electronic traffic analyser; and
- (b) the Electro-matic radar speed meter manufactured by the Automatic Signal Division of the Laboratory for Electronics, Norwalk, Conn., U.S.A.

Overhang-
ing loads
(Section
7(b))

24. Every vehicle carrying an overhanging load shall mark such load in the following manner —

- (a) by day with a red flag at least one foot by one foot in size at each point where such load projects outside the profile of the vehicle;
- (b) by night with a white light to the front, a red light to the rear and an amber light to the sides at each point where such load projects beyond the profile of the vehicle.

Where the overhanging load projects beyond three feet over either side of the vehicle, such vehicle shall not move unless accompanied by a police escort at such time and date as the Commissioner shall order after he has been requested so to do by not less than 48 hours notice in writing.

Governor may
disapprove
of accessories
(Section
7(d))

25. The Governor may, on the advice of the Commissioner, disapprove of any crash helmet, driving mirror, windscreen wiper, horn, light, speedometer or other piece of equipment for use on a vehicle if it appears that such piece of equipment is —

- (a) unsafe;
- (b) likely to be a nuisance to the public; or
- (c) inadequate for the purpose for which it appears to be intended;

and such disapproved piece of equipment shall not be used for, carrier in any vehicle, neither shall it be imported into or sold in the Islands for use with a vehicle.

(2) Every vehicle imported into or used in the Islands which would otherwise be likely to cause interference with radio reception by the public shall be equipped with effective radio interference suppressors.

Tow ropes
(Section
7(d))

26. Where any driver of a vehicle uses a tow rope for the purpose of towing another vehicle such tow rope —

- (a) shall not exceed 15 feet in length; and
- (b) shall be marked with pieces of red cloth or by some other means so as to render it clearly visible to other road users.

Fees.

27. The following fees are prescribed in connection with inspection, registration and licensing under the Law.

Section	Subject	Fee
6	Vehicle Inspection	\$ 2
11 (d) and	Vehicle Registration and re- registration (per annum)	
25	Bicycles	2
	Motorcycles	12
	Motorcars	24
	Station Wagons	32
	Rent-a-Cars	40
	Rent-a-Motorcycles	16
	Taxis	32
	Onmibuses up to 10 passengers	40
	Do 20	50
	do 30	60
	do over 30	70
	Trucks not exceeding 1 ton capacity	40
	do 3	56
	do 5	64
	do over 5	80
Provided that when the annual fee amounts to \$24 or more it may be paid by quarterly installments or multiples thereof.		
	Trailers not over 2 ton capacity	12
	do Over 2	24
	Invalid carriages	nil
	Special	80

	Section	Subject	Fee
		Locomotives	64
	27	Licence plate replacement	2
	28 (3)	Trade plate rental per quarter	
		First set	25
		Second set	15
		Third set	10
	35	Driving permit for foreign licensee	2
	39	Provisional driving licence	1
	41 (2)	Driving test	3
	42 (3)	Driving licence (up to 3 years)	5
	43 (1)	Taxi drivers licence (per annum)	2
Road code. (Section 77(g))	28.	The road code is prescribed in a separate schedule.	
Old Regulations revoked.	29.	All regulations made under the old Law are hereby revoked.	

THE SCHEDULE

(Regulation 3)

Prescribed Forms

INDEX

No.	Section	Subject
T.R. 1	3 (1) and 24 (1)	Certificate of Roadworthiness of a Vehicle.
2	8	Direction for dealing with Unroadworthy Vehicle.
3	16	Application for Registration of a Vehicle.
4	17	Register of Vehicles.
5	18	Certificate of Registration of a Vehicle.

6	19 (1)	Alteration of Particulars of Registration.
7	22	Termination of Registration of a Vehicle.
	23	Application for Suspension of Registration of a Vehicle.
8	24 (3)	Report of a Vehicle being beyond repair.
9	24 (4)	Notification of Vehicle being under repair at time for registration renewal.
10	27	Application for New Licence Plate.
11	28 (3)	Application for Trade Plates.
12	34 (3)	Medical Certificate of Competence to Drive.
13	35	Visitors Permit to Drive.
14	39 & 42 (3)	Application for a Driving Licence.
15	39	Provisional Driving Licence.
16	41 (2)	Application for a Driving Test.
17	42 (1)	Certificate of Competence to Drive.
18	42 (3) and 43 (1)	Driving Licence.
19	43 (1)	Application for a Taxi or Omnibus Driver's Licence.
20	68 (2)	Traffic Ticket.

FORM TR. 1. TRAFFIC DEPARTMENT
 TRAFFIC LAW Vehicle Inspection Check Sheet

SECTIONS 3(1) & 24(1) (Certificate of Roadworthiness)

Name & Address

Reg. No.

Make & Class

Serial/Engine No.

Engine

R.V. Mirror

Steering

Wiper

Chassis

Horn

Locks (door)

No. plate

Head Light (s)

Body work

Tail Lights

Tyres

Dip switch

Hubs

Flashing indicator

Spare tyre

Brake light

Wind screen

Hand brake

Speedometer

Foot brake

Silencer

Other

Gears (reverse)

FAILED for defects listed above

Vehicle Inspector

Date

Defects remedied to my satisfaction

Passed in Class _____

Passengers _____ Standing Passengers _____ Tonnage _____

Special features _____

Date

Vehicle Examiner

FEES \$2.00

Collected/NOT COLLECTED

Form T.R. 2

THE TRAFFIC LAW

(Section 8)

TO BE COMPLETED IN DUPLICATE

CERTIFICATE OF DEFECTS

No. _____

I hereby certify that the under-mentioned Motor Vehicle is not in a fit condition to be on or in any public road or place _____

I issue this certificate on account of the following defects:— _____

and I am of the opinion that these defects can/cannot be remedied.

Vehicle Inspector or Police Officer

Date: _____

Form T.R. 3 THE TRAFFIC LAW — Section 16.

Official Use
Only.**Application to Register a Vehicle**

Reg. No.

2)

3)

Fee: \$

Receipt No.

Surname of Applicant* _____

Given Names _____

Full Home Address _____

If Company, Office Address _____

Category of Vehicle _____ (Note "A")

Make of Vehicle _____ Year of Manufacture _____

Colour of Vehicle _____ Cylinder Capacity _____

Chassis or Frame number _____ Engine Number _____

Seating Capacity _____ (If omnibus number of standing passengers for which vehicle is designed to carry) _____

Maximum load capacity (if a truck) _____

Unladen Weight of vehicle _____ (only if truck or special vehicle)

INSURANCE PARTICULARS:—

Company issuing cover _____

Date of Issue _____ Type of Policy:— Statutory/Comprehensive

Cert. Number _____

Date of Expiry _____

I certify that the foregoing information is correct**

Date _____ Signature of Applicant _____

Note "A" Types of vehicles are:— Motorcycles; Motorcars; Station Wagons; Rent-a-Cars; Taxis; Omnibus not exceeding (1) 10 passengers; (2) 20 passengers; (3) 30 passengers, and (4) over 30 passengers; Trucks not exceeding (a) 1 ton; (b) 3 tons; (c) 5 tons; and trucks over 5 tons; trailer not exceeding a load capacity of 2 shipping tons; trailer exceeding 2 shipping tons; Invalid carriages; Special Vehicles; Locomotives.

* If vehicle is to be registered in a Company's name place name of company in first line.

** A false declaration is punishable by a fine not exceeding \$200 or to imprisonment for a term not exceeding six months or both.

THIS APPLICATION MUST BE ACCOMPANIED BY A CURRENT INSURANCE CERTIFICATE AND A CERTIFICATE OF ROAD-WORTHINESS (T.R. 1) ISSUED BY THE POLICE.

CAYMAN ISLANDS GOVERNMENT VEHICLE LICENSING AUTHORITY

ORIGINAL REGISTERED NUMBER: _____

PRIVATE CAR	NEW
MOTORCYCLE	OLD
STATION WAGON	PRIVATE
RENT-A-CAR	
RENT-A-M'CYCLE	
TAXI	
OMN. BUS	
TRUCK TO 1 TON	
TRUCK TO 3 TONS	
TRUCK TO 5 TONS	
TRUCK 5 PLUS	
TRAILER TO 2	
TRAILER 2 PLUS	
INVALID CARRIAGE	
SPECIAL VEHICLES	
LOCOMOTIVE	
OTHER	
MAKE _____	REGISTERED OWNER & ADDRESS _____
ENGINE NO. _____	_____ TEL. _____
BODY FRAME NO. _____	1st CHANGE: DATE 1 17 TO _____
YEAR _____	_____ TEL. _____
COLOUR _____	2nd CHANGE: Date 1 17. TO _____
SEATING _____	_____ TEL. _____
NO. WHEELS _____	3rd CHANGE: Date 1 17. TO _____
WEIGHT _____	_____ TEL. _____
UNLADEN _____	4th CHANGE: Date 1 1. TO _____
CUBIC C. _____	_____ TEL. _____
STANDING PASSENGERS _____	5th CHANGE: Date 1 1. TO _____
PASSENGERS _____	_____ TEL. _____
MAXIMUM _____	_____ TEL. _____
LOAD _____	_____ TEL. _____
ALTERATIONS _____	_____ TEL. _____

YEAR	1st	2nd	3rd	4th	DATE	VEHICLE EXAMINER	SUSPENSION
1974							
1975							
1976							
1977							
1978							
1979							
1980							
1981							
1982							
1983							
1984							
1985							

T.R. 5

TRAFFIC LAW — (Section 18)

MOTOR VEHICLE CERTIFICATE OF REGISTRATION

Page 1

Registration Number _____

PARTICULARS OF VEHICLE

- (1) Category of Vehicle _____
- (2) Make of Vehicle _____
- (3) Year of Manufacture _____
- (4) Colour of Vehicle _____
- (5) Chassis Number* _____
- (6) Frame Number* _____
- (7) Engine Number _____
- (8) Cylinder Capacity _____
- (9) Seating Capacity _____ (if omnibus number
of standing passengers) _____
- (10) Maximum Weight of load to be Carried _____
- (11) Unladen Weight of Vehicle _____

Notes:-

- (a) "*" — delete either (5) or (6) whichever does not apply.
- (b) "(10)" and "(11)" apply to Trucks, Special Vehicles and Trailers only.

OFFICIAL USE ONLY

This Certificate of Registration was issued on _____

At _____ am/pm _____ At _____

By _____

Signature of Issuing Officer

PARTIFULARS OF OWNER

<u>Page 2</u>	<u>Page 3</u>
<u>Surname</u> _____ <u>Company</u> _____ <u>Given Name(s)</u> _____ <u>Full Home Address</u> _____ _____	4th Change of Ownership
1st Change of Ownership <div align="center"> 1/2" <div align="center"> <div align="center">1/2"</div> <div align="center"> <div align="center">rubber stamp</div> </div> </div> </div>	5th Change of Ownership
2nd Change of Ownership	6th Change of Ownership
3rd Change of Ownership	7th Change of Ownership

Page 4

CHANGE OF VEHICLE PARTICULARS

Engine Number_____

Colour_____

Category of Vehicle_____

Cylinder Capacity_____

1/2" x 1/2" rubber stamp

Page 5

RENEWALS OF VEHICLE LICENCE

[illegible]

Page 6

RENEWALS OF VEHICLE LICENCE

Form T.R. 3

TO BE COMPLETED IN DUPLICATE

**ALTERATIONS OF PARTICULARS OF
A REGISTERED MOTOR VEHICLE.**

(Section 19(1) of the Traffic Law.

I, _____ of _____
the registered owner of motor vehicle(s) _____,
do hereby inform the Licensing
Authority, that the following particulars are now changed in respect to the
said motor vehicle.

(a) That the said motor vehicle is now to be transferred into the name
of _____ residing at _____

(b) That the colour of the vehicle has been changed from _____ to _____

(c) That the engine has been changed from a _____
to a _____ and that the new engine
number is _____

(d) That the vehicle is no longer to be registered as _____
_____ and is now to be registered as a _____

DATE _____

Signed _____

NOTE: Fill in only the section relating to the change of particulars. It is an offence to use a motor vehicle on the road if the registration particulars have not been notified to the Licensing Authority within seven (7) days. If a change of ownership has taken effect, then the new owner will fill in the appropriate form for re-registration of the vehicle in his name as if the vehicle were new.

Form T.R. 7
(IN DUPLICATE)

APPLICATION FOR SUSPENSION of VEHICLE LICENCE
TERMINATION

The Traffic Law Sections 22 and 23

I _____
do hereby make application that the vehicle licence for the following
vehicle(s) be suspended/terminated* as from _____
_____ until _____ (**), and that the appropriate funds be
refunded to me..

Date: _____ Signed: _____

* Delete which one is not applicable.

(**) Refers to suspension only. State which date you wish the vehicle
relicensed.

THIS APPLICATION MUST BE ACCOMPANIED BY THE LICENCE
PLATES AND THE CERTIFICATE OF REGISTRATION, AS WELL AS
THE CURRENT LICENCE COUPON.

(SEE BACK OF FORM).

BACK OF FORM

I hereby certify that vehicle registration number _____, has
been exported from the Islands on the _____ day of
_____ by the SS "_____".

Date: _____ Signed: _____
Customs Officer

I hereby certify that vehicle Registration Number _____
was on _____ the _____ day
of _____, disposed of to the satisfaction of the
Public Health Department.

Date: _____ Signed: _____
Public Health Officer

NOTE: Only Part I or Part II must be filled in.

Form T.R. 8

THE TRAFFIC LAW, Section 24(3)

Number _____ Notification to Licensing Authority from
Police that Vehicle is beyond Repair.

This is to certify that I have, on _____ 19____, examined
vehicle Registration Number _____, which is a
_____ and have found that it is
beyond repair.

Date: _____ Signed: _____
Vehicle Inspector

Form T.R. 9

Notification to Vehicle Inspector that Motor Vehicle Is
presently under Repair. No. _____

THE TRAFFIC LAW, Section 24(4)

I _____ of _____
do hereby notify the Authority that the following motor vehicle(s) registered
in the name of _____ and the
registration of which is due for renewal is/are presently under repair, and can
be seen at the premises of _____
_____ located at _____.

The vehicle(s) is/are expected to be off the road for approximately
_____ weeks so that repairs may be effected.

Date: _____ Signed: _____

Particulars of vehicle(s) off the road.

- (a) _____
(b) _____
(c) _____
(d) _____

NOTE: The above form will be in duplicate. Original to Police, copy to
Licensing Authority.

Form T.R. 10

THE TRAFFIC LAW
(Section 27)**TO BE COMPLETED
IN DUPLICATE.**Original to
Licensing Authority,
copy to the
Police Traffic Department.**APPLICATION FOR A NEW LICENCE PLATE**I, _____ of _____
the registered owner of vehicle number _____, do hereby
apply for new number plates to be issued in respect of the above vehicle.

I certify that the original plates have been lost.*

* Delete the above line if the old plates are being surrendered.

I tender with this application, the fee of two dollars.

Date: _____ Signed: _____

FOR OFFICIAL USE ONLY

Fee Received _____ New Number Issued _____

Signature: _____

Licensing Authority.

Form T.R. 11

APPLICATION FOR MOTOR TRADE PLATES

Traffic Law, Section 28(3)

NAME OF APPLICANT _____

BUSINESS ADDRESS _____

TYPE OF BUSINESS _____

NUMBER OF SETS REQUIRED (1, 2, or 3) _____

PERIOD REQUIRED (Not less than 3 months) _____

INSURANCE PARTICULARS:

(a) Cover Note/Policy No. _____

(b) Issued by _____

(c) Valid Until _____

Office Use Only

Issued _____

Expire _____

1 _____

2 _____

3 _____

Fees: per Quarter

1st - \$25

2nd - \$15

3rd - \$10

Total: \$ _____

PERSON RESPONSIBLE FOR CUSTODY OF THE PLATES

Date: _____ Signature: _____

For (Company) _____

NOTE: The plates issued under this Section remain at all times the property
of the Licensing Authority, who, may from time to time state under what
conditions such plates may be used.**MUST BE ACCOMPANIED BY THE APPROPRIATE TRADES AND
BUSINESS LICENCE.**

Form T.R. 12

TRAFFIC LAW
Section 34(3)

MEDICAL CERTIFICATE

NOTICE TO MEDICAL
EXAMINERS:

It is particularly to be observed that in cases of doubt as regards Applicant, the interest of the public should have precedence over the interest of the Applicant.

Name in full: Residence of Applicant and date of birth

1. Eyesight _____ Right eye _____ Left eye _____ (standard,
not less than 6/12)
with glasses _____ with glasses (with spectacles)
2. Colour vision _____
3. Hearing _____
(a) Is hearing defective? _____
(b) If so, is it to a degree inconsistent with driving safety? _____
4. Any disease of the central nervous system? _____
5. Is the Applicant suffering from any disease or condition of the Cardio Vascular System which renders him unfit or unsafe to drive a Motor Vehicle? _____
6. Does the Applicant to your knowledge suffer from epilepsy, aneurism, angina pectora? _____

Date _____

_____ Medical Examiner.

Form T.R. 13

THE TRAFFIC LAW
(Section 35)

(IN DUPLICATE)

Visitors Driving Permit

Fee paid \$ _____

Issued by _____

Full Name of Holder _____

Full Address in Cayman _____

Date of Birth _____

Driving Licence No. _____

Country and/or State of Issue _____

Class of Vehicle Permitted Drive _____

Date of Expiry of Licence _____

Signature of Holder _____

THIS DOCUMENT IS VALID FOR SIX MONTHS ONLY OR FOR
DURATION OF STAY WHICHEVER PERIOD IS THE SHORTER.

Form T.R. 14 APPLICATION FOR A DRIVING LICENCE

Traffic Law, Sections 39 & 42(3)

NOTE: THIS APPLICATION DOES NOT APPLY TO
PERSONS WISHING TO OBTAIN A VISITORS
DRIVING PERMIT UNDER SECTION 35.

Surname _____ Date of Birth _____
Given Name(s) _____ Sex: Male _____ Female _____
Full Home Address _____ Telephone _____

Official
Use Only
Provisional
D/L
Number _____
Expires _____
Full D/L
Number _____
Book Number _____

Do you Suffer from any Physical or
Mental Disability (See note "A") _____ Height _____
Colour of eyes _____
Colour of hair _____

If answer is Yes; State disability _____

Do You wish a Full Provisional Licence (See Note "B") _____

For what class of Vehicle(s) _____

If you are non-Caymanian and wish to Claim Exemption from a Driving Test
under Note "C" below; give following particulars:

(1) When and where was your Licence issued: _____

(2) For what class of Vehicle is it valid: _____

(3) When does it expire: _____

Are you disqualified by a Court of Law or by any other reason from holding a
Drivers Licence. _____

* Delete which is inapplicable.

DECLARATION:

I hereby solemnly declare that the above information is true, and that I am
not disqualified from holding a drivers licence.

Signature of Applicant _____ Date _____ 19 _____

Note "A": The Disabilities are any of the following: Total deafness;
insanity; epilepsy; defective vision less than 6/12 with
glasses; aneurysm; angina pectora; loss of one hand or one
foot; diseases of the nervous system giving rise to lack of
muscular co-ordination.

Note "B": A provisional licence is valid for six (6) months, and is for all
persons wishing to be tested unless exempted under Note
"C" below. You must state the type of vehicle(s) you wish to
learn to drive.

Note "C": If you are a resident of: Jamaica, Canada, U.S.A. or the
United Kingdom, and hold a valid drivers licence for one of
these countries, (or one which has expired by no more than
three (3) months), then you may apply for an exemption
from the driving test, on production of the said licence.

Note "D": A FALSE DECLARATION IS PUNISHABLE BY A FINE
NOT EXCEEDING \$200 OR TO IMPRISONMENT FOR
A TERM NOT EXCEEDING THREE MONTHS OR
BOTH.

THE TRAFFIC LAW
(Section 39)

Number_____
CAYMAN ISLANDS LICENSING AUTHORITY PROVISIONAL DRIVING LICENCE. P
Name_____
Address_____
IS HEREBY PERMITTED TO DRIVE VEHICLE(S) OF GROUP _____
SUBJECT TO PROVISIONS OF SECTION 40 OF THE TRAFFIC LAW.
DATE OF ISSUE _____
TIME OF ISSUE _____
DATE OF EXPIRY _____
Issued by: _____
LICENSING AUTHORITY

Form of Provisional Driving
Licence.

The Licence shall be in duplicate,
the original being perforated at its
edge to be torn out of a book, the
duplicate remaining in the book.
The licence shall be white in
colour with red printing. The
duplicate shall be of a different
colour with black printing.

Form T.R. 16

THE TRAFFIC LAW
(Section 41(2))

No. _____

APPLICATION FOR DRIVING TEST

To the Licensing Authority for _____
do hereby apply for a Driving Test and I do hereby solemnly declare that I
am not disqualified for obtaining a Driver's Licence and the information
contained herein is true.

Signature of Applicant

ENCLOSURES:

(a) Surname _____ Block Letters _____

(b) Given Name(s) _____

(c) Full Home Address _____

(d) Age next Birthday _____

(e) Date and place of Birth _____

Signature of Applicant

FOR POLICE USE ONLY.

(1) Percentage gained on written examination _____ %
(Pass/Fail).

(2) Pass/Fail on manoeuvres. _____

(3) Provisional Driving Licence number _____

Exemptions from Test.

Country of Issue _____ Date of Issue _____

Date of Expiry _____

Date of Test _____

Signature of Certifying Officer

Department

**NOTE: THIS APPLICATION MUST BE ATTACHED TO THE
EXAMINATION AP PAPER BY THE CERTIFYING OFFICER, AND
THE EXAMINATION PAPER MUST BE FILLED IN, IN THE AP-
PLICANT'S HANDWRITING.**

Form T.R. 17

TRAFFIC LAW

(Section 42(1))

CERTIFICATE OF COMPETENCE TO DRIVE A MOTOR VEHICLE

No. _____

THIS IS TO CERTIFY THAT ON _____
 SURNAME _____
 GIVEN NAME(S) _____
 DATE OF BIRTH _____
 _____ OF _____

HAS PASSED THE PRESCRIBED TEST* UNDER SECTION 36(1) OF THE
IS EXEMPT FROM THE PRESCRIBED TEST

ABOVE LAW, AND IS COMPETENT TO DRIVE _____

IN THE CAYMAN ISLANDS.

PARTICULARS PROVISIONAL LICENCE* EXEMPTION (not being a
 OF: PRODUCED LICENCE UNDER provisional licence)

NUMBER _____ ISSUED BY _____
 ISSUED ON _____ VALID*
 EXPIRED (Not more than three months)
 Date _____

 Signature of Driving Examiner.

Note: * Delete whichever is not applicable.

Form T.R. 18

DRIVING LICENCE (to be printed in book form)

(Section 42(3) and 43(1))

CAYMAN ISLANDS**DRIVING LICENCE**

No. _____

**AGE GROUPS FOR HOLDING
DRIVING LICENCE AND CONDITIONS
ATTACHED THERETO**

-
- 1) 17 yrs.: Motor Car; Motor Cycle; Rent-a-Car.
- 2) 18 yrs.: Vehicles in Group (1) including a truck not exceeding three tons.
- Over 21: All other vehicles and a Taxi, if approved by Commissioner of Police.
-

NOTE

Before a Full Licence is issued you must either (a) obtain a Provisional Licence for the class of vehicle which you wish to drive and then sit the prescribed test or (b) be exempt from the test under Section 38(1) of the Traffic Law. You must be qualified under the Law.

This page must not be removed or defaced

**ALL PROVISIONAL DRIVING
LICENCES TO BE ATTACHED
TO THIS PAGE.**

This page must not be removed or defaced

**FOR TAXI DRIVERS LICENCE ONLY
PHOTOGRAPH TO BE ATTACHED HERE**

This page must not be removed or defaced

Page 4

RENEWALS TO BE ENTERED HERE

This page must not be removed or defaced

Page 5

FULL PARTICULARS OF HOLDER

Surname _____

Given name(s) _____

Full Home Address _____

Sex Male Height _____
Female

Colour of Eyes _____

Colour of Hair _____

Usual Signature of Licence Holder _____

This page must not be removed or defaced

OFFICIAL USE ONLY

Driving Licence Number _____

Issued on _____

at _____ am/pm and valid until _____

The Holder may drive the following category of vehicles.

GROUP NO.	DATE	SIGNATURE OF ISSUING OFFICER.

This page must not be removed or defaced

Page 7

(BLANK PAGE)

This page must not be removed or defaced

Page 8

(BLANK PAGE)

This page must not be removed or defaced

(BLANK PAGE)

This page must not be removed or defaced

NOTES TO PROVISIONAL LICENCE HOLDERS

A) The following are the classes of vehicles for which Provisional Licenses are issued:

- (1) Motor Cycle - 17 yrs. and over;
 - (2) Motor Car; Station Wagon; Rent-a-Car - 17 yrs. and over
 - (3) Vehicles in group (2), including a truck not exceeding three tons - 18 yrs. and over
 - (4) All other vehicles except group (1) - 21 yrs. and over.
-

When learning to drive you MUST

- (i) Be in possession of a valid Provisional Driving License.
- (ii) Be the correct age for that class of vehicle.
- (iii) Display the prescribed "L" plates on the vehicle driven.
- (iv) Be accompanied by a qualified driver for that class of vehicle, who has held the licence for 12 months (other than class 1).

This page must not be removed or defaced.

FORM OF ENDORSEMENT ON DRIVING LICENCE

(Section 71(1))

<p>The Holder of this Licence has on the day__of_____, 19____ been convicted of_____</p> <p>in__the__Court _____</p> <p>at _____ and ____ is disqualified from obtaining or holding a Drivers Licence until _____</p> <p>Clerk of Court _____</p>

Stamp of
disqualifi-
cation for
insertion in
driving
licences.

Form T.R. 19

THE TRAFFIC LAW
(Section 43(1))

APPLICATION FOR A LICENCE TO DRIVE
A TAXI OR OMNIBUS.

Surname _____ (Block Letters)
 Given Names _____
 Date of Birth _____
 Full Home Address _____

GIVE THE FOLLOWING DETAILS OF YOUR
PRESENT DRIVING LICENCE:—

- (1) When was it issued: _____
 (2) What is the number: _____
 (3) For what class of vehicle(s) is it valid _____
 (4) When does it expire _____

FOR OFFICIAL
USE.

Date _____

Granted
Yes/No _____

Police
No _____

Signature
of Issuing
Officer _____

Issued _____

Withdrawn _____

Re-issued _____

Fee Paid
\$ _____

Have you, in the past FIVE years been convicted of any of the offences under
Note "A" below _____ Yes/No.

If yes, set out particulars in full _____
 date _____ offence _____ sentence _____

for whom do you intend to work, (if self, state "self", if otherwise give full
name and address of employer) _____

DECLARATION:

I hereby solemnly declare that the above information is correct.

Date: _____ Signed: _____

POLICE REPORT ON APPLICANT AND
CONVICTIONS RECORDED AFTER
LICENCE IS ISSUED.

Photograph of Applicant
(Passport Size).

Form T.R. 19 Continued

- Note "A": (1) An offence under paragraph (a) or (b) of Section 61 of the Traffic Law, or Section 18 of the Motor Vehicle Law, Cap. 106.
- (2) Any offence involving dishonesty.
 - (3) Any offence connected with Dangerous Drugs.
 - (4) Any offence against the person.
 - (5) Any offence against sections 64 or 65 of the Traffic Law.

IMPORTANT: THIS APPLICATION MUST BE ACCOMPANIED BY TWO PHOTOGRAPHS OF THE APPLICANT.

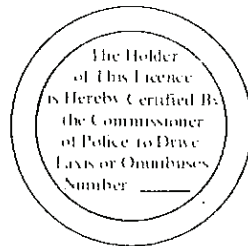

Stamp of endorsement on driving licence (T.R. 18) of a person licensed to drive a Taxi or Omnibus.

Form T.R. 21

TRAFFIC LAW
(Section 68(2))

No. _____

Traffic Ticket Original.

Mr. Mrs. Miss _____

Surname _____ Date of Birth _____

Given Names _____

Full Home Address _____

Occupation _____ Registration No. of Vehicle _____

Make of vehicle _____

Type of vehicle _____ Driving licence No. _____

Insurance: Correct/Incorrect _____ Driving licence: Correct/Incorrect _____

OFFENCE	C/S	FINE (\$)
Mixed or unsound tyres	53 (1) (a)	\$20
Damaged or non-aligned wheels or tracks	53 (1) (b)	\$25
Inefficient steering	53 (1) (c)	\$25
Inefficient or defective brakes	53 (1) (d)	\$25
Defective lighting or reflector	53 (1) (e)	\$15
No effective horn	53 (1) (f)	\$10
No effective driving mirror	53 (1) (g)	\$10
Ineffective trafficator	53 (2) (a)	\$20
Defective windscreen wiper	53 (2) (b)	\$10
Defective silencer	53 (2) (c)	\$25
Defective safety glass	53 (2) (d)	\$10
Defective bumper	53 (2) (e)	\$10
Faulty power unit	53 (2) (f)	\$10
Defective silencer M/C	53 (3) (a)	\$25
Defective power unit M/C	53 (3) (b)	\$10
No approved crash helmet M/C	53 (4)	\$10
Obscured vision	53 (5) (a)	\$10
Overhanging load	53 (5) (b)	\$20
Defective bodywork	53 (5) (c)	\$25
Overloaded with goods	53 (5) (d)	\$25
Excess passengers	53 (5) (d)	\$10 per passenger
Without efficient speedometer	53 (6)	\$10
Driving without full control	55 (a)	\$25
Driving on incorrect side	55 (b)	\$15
Turning to right without proper warning	55 (c)	\$20
Failing to comply with traffic sign or signal	55 (d)	\$15

Form T.R. 21 Continued

Failing to comply with police signal or order	55 (e)	\$25
Driving too close to another vehicle	55 (f)	\$20
Failure to keep look-out	55 (g)	\$20
Failure to give required signal	55 (h)	\$20
Driving so as to obstruct another vehicle	55 (i)	\$25
Permitting vehicle to obstruct another when stationary	55 (j)	\$25
Driving too fast for field of vision	55 (k)	\$25
Lack of care at intersection	55 (l)	\$15
Obstruction by parking	55 (m)	\$25
Failure to give way to emergency vehicle	55 (n)	\$25
Driving with defective lights at night	55 (o)	\$20
Failure to comply with Road Code	56 (1)	\$15
Irregular parking	56 (2)	\$20
Irregular parking	68 (1) (a)	\$25
No proper licence plate	68 (1) (i)	\$10
Unsound silencer or muffler when driving	68 (1) (j)	\$25
Emitting obnoxious fumes etc.	68 (1) (k)	\$10
Misuse of horn	68 (1) (k)	\$20
Misuse of light	68 (1) (l)	\$25
Obstructing emergency vehicle	68 (1) (o)	\$25
Leaving vehicle unattended with engine running	68 (1) (t)	\$10

Committed at _____ on _____ / - _____ / _____ at
 _____ hrs. Reporting Officer: _____
 No. _____ Dept. _____

You are hereby summoned to appear at the Court House in George
 Town/Cayman Brac, at _____ hrs. _____ on
 _____ 19____, OR, In the alternative you may produce this
 ticket, together with your driving licence, to the Clerk of the Court, at any
 time during business hours prior to the said date, and pay to the Clerk of the
 Court the sum of \$ _____

Failure to comply with either of the above alternatives will render you liable
 to be arrested and brought before the Court.

Original to offender

Copy No. 1 to Court

Copy No. 2 to prosecutor

Copy No. 3 with police.

(Regulation 4)

Licence plates required to be prescribed by section 11 (iii) shall be 6" in height and 12" or upwards in length and the figures and letters depicted thereon shall be 3" in height. The colours thereof shall be as follows:—

Motor cars)	
Motorcycles)	Yellow background with black numbers
Station wagons (not taxis))	
Rent-a-Car)	White background with black numbers
Rent-a-m/c)	
Taxis)	
Omnibuses)	White background with red numbers
Station wagons licensed as taxis)	
Trucks)	
Trailers)	Orange background with black numbers
Locomotives)	
Invalid carriages)	Yellow background with red numbers
Special Vehicles)	Orange background with green numbers
Other categories)	As for special vehicles

or such other colours as have been or may be issued by the Licensing Authority from time to time.

Bicycle tags required to be prescribed by section 11 (iv) shall be of the shape and dimension illustrated and shall be in colour with black lettering and figures of the dimensions shown:—

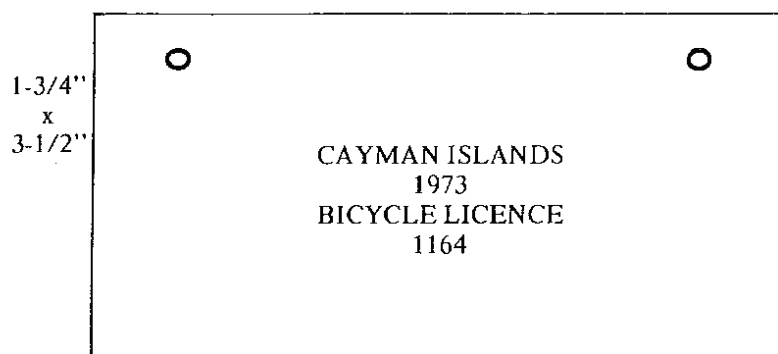

The Coupon shall be of the dimensions and in the form illustrated with the appropriate figure in the centre.

No. _____	
<div style="text-align: center;"><p>CAYMAN ISLANDS</p><p>No. _____</p><p>JUN 74</p><hr/><p>Reg. No. CI _____ Make _____ Date Stamp _____</p><p>TRAFFIC LAW 1973</p></div>	
Inspection Fee \$	Total Fee(s) \$
License Fee \$	Issuing Officer _____

Appropriately numbered, dated and detailed.

(Regulation 9)

The "L" plates required by section 40 to be prescribed shall be a red "L" on a white background of the dimensions illustrated:—

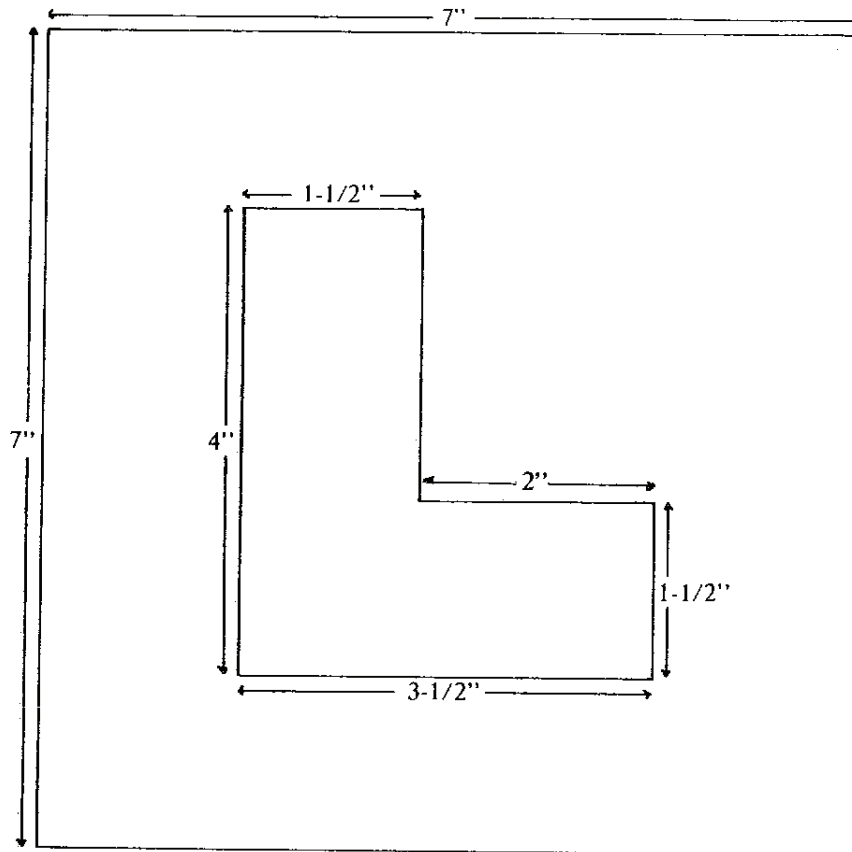

Made in Council this 17th day of December, 1974.

JENNY MANDERSON
Clerk of the Executive Council

Government Notice No. 349 of 1974
Date of operation: 18th December, 1974

(Price \$9.60)