

CAYMAN ISLANDS



CAYMAN ISLANDS
LAW SCHOOL

Supplement No. 1 printed with Gazette No. 22 of 1985

**THE CUSTOMS LAW (SECOND REVISION)
CUSTOMS (PRESCRIBED WAREHOUSE)
(AMENDMENT)
(NO. 2) REGULATIONS, 1985**

**THE CUSTOMS LAW (SECOND REVISION)
CUSTOMS (PRESCRIBED WAREHOUSE) (AMENDMENT)
(NO. 2) REGULATIONS, 1985**

In exercise of the powers conferred on the Governor in Council by section 2 and by paragraph (c) of section 73 of the Customs Law (Second Revision), the following Regulations are hereby made -

- Citation.

1. These Regulations may be cited as the Customs (Prescribed Warehouse) (Amendment) (No. 2) Regulations, 1985.
- Substitution of First Schedule.

2. The First Schedule to the Customs (Prescribed Warehouse) Regulations, 1981 (as amended by the Customs (Prescribed Warehouse) (Amendment) Regulations, 1985) is amended by substituting the following for the First Schedule -

“FIRST SCHEDULE

That part of the building shaded in the floor plan depicted hereunder located at the Airport Industrial Park on property described as Block 20B Parcel 209 George Town East being part of the building known as Gayisle Enterprises Limited.

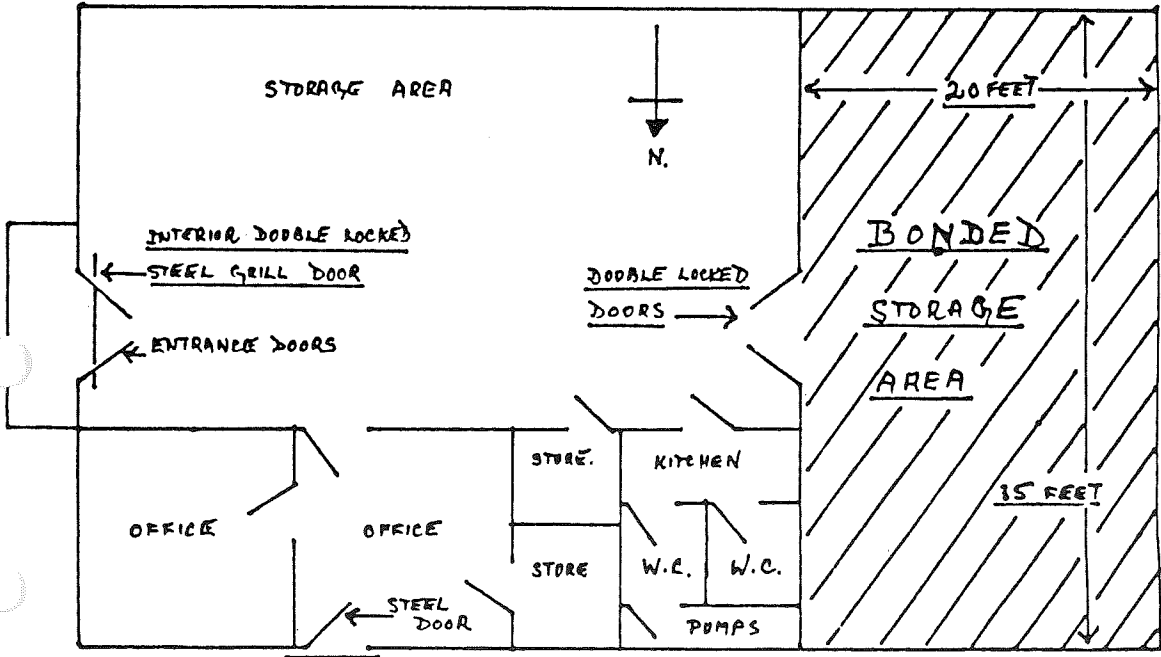

Made in Council this 1st day of October, 1985.

JENNY MANDERSON
Clerk of the Executive Council.

